



The light woven tote bag

OS 160 GSM

Description

Top edge double-folded for strength and a clean finish
Long handles in self-fabric reinforced with cross-stitching

Composition

Shell - Plain Weave
100% Cotton - Organic Ring Spun Combed - 160.0 GSM
Fabric washed

Care instruction

Wash similar colours together, no ironing on print, wash and iron inside out.



Country of origin

Weaving : Bangladesh
Dyeing : Bangladesh
Assembly : Bangladesh

Whites



Colors

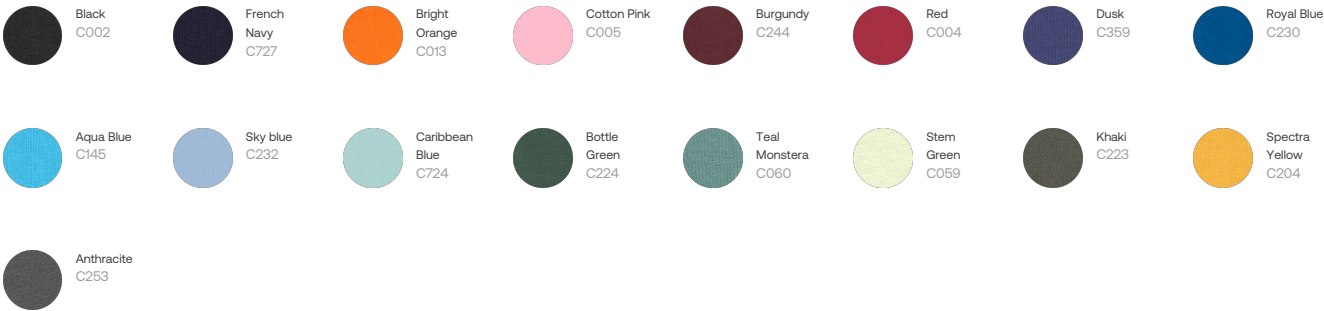

Size Guide

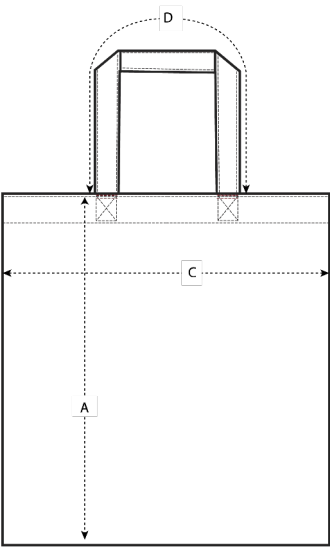

Measurement in cm	OS
A - Height	42
C - Width	37
D - Strap Length	65

Packing

Sizes	OS
Pieces / bag	20
Pieces / box	200